

DONALDSON PARK

Improve play, park and main entrance on South Street.

issues to consider

- Improve main entrance to park
- Make Play area and Park bigger and better.
- Improvements to Park.

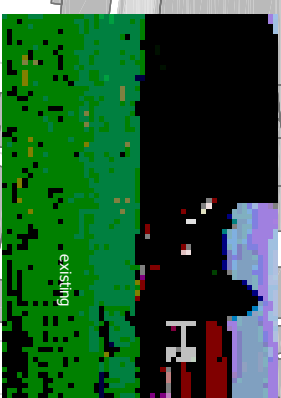

design PROPOSALS

- Improvements to Play Area, South Street entrance and car park
- Wildflower and bulb planting areas. Used to enhance the space, increase biodiversity and discourage the use of the hill as a hang out spot.
- Possible New Footpath
- New Tree Planting

Play Area

design PROPOSALS

- Possible Youth Area subject to funding*.
- With shelter, seating and basketball net.
- Addition of natural play elements. Logs, boulders and mounding.
- Replace Swing.
- Improve seating area on the path.
- Fruit Trees



surfacing PROPOSALS

- safety surfacing
- cobbles setts

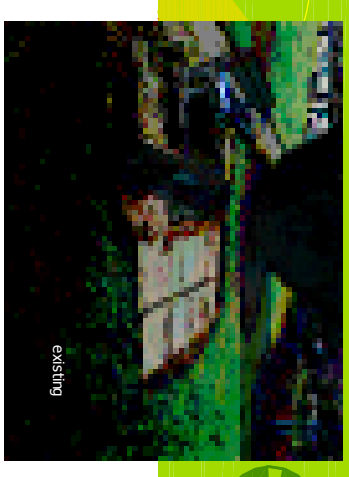
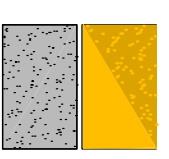

South Street Entrance

design PROPOSALS

- Formalise entrance with low hedge and bulbs
- Possible edge and re-surface of driveway
- Top up red chips
- Paint railings and gate
- Park Sign at entrance

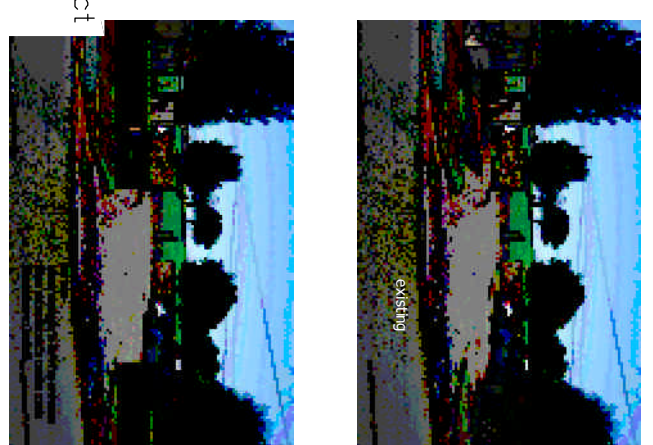
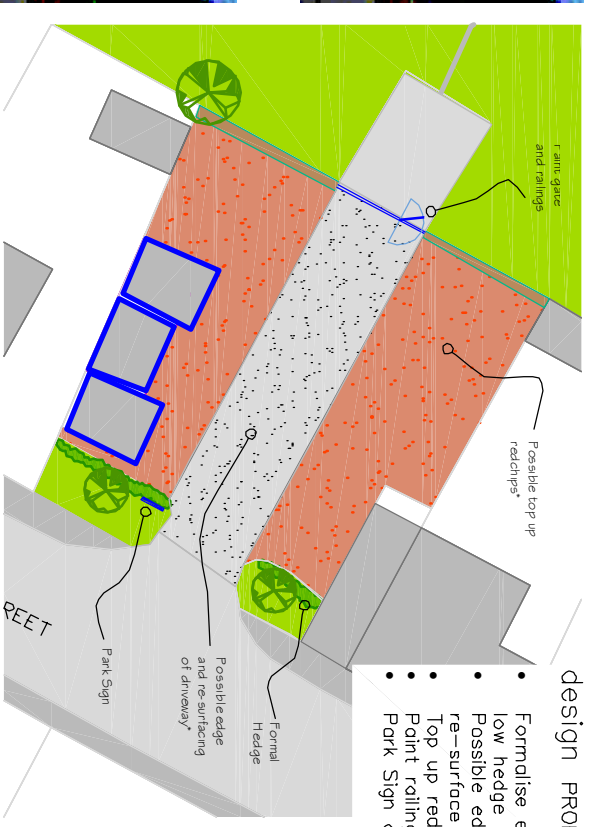

* 'possible' items are subject to landownership and budget available.



NOT TO SCALE
 Reproduced by permission of Ordnance Survey on behalf of HMS
 © Crown Copyright and the Controller of Her Majesty's Stationery Office
 All Rights Reserved Ordnance Survey Licence number 10002971.