

PROPOSED TRASH
SCREENS IN MYRE
PLAYING FIELDS

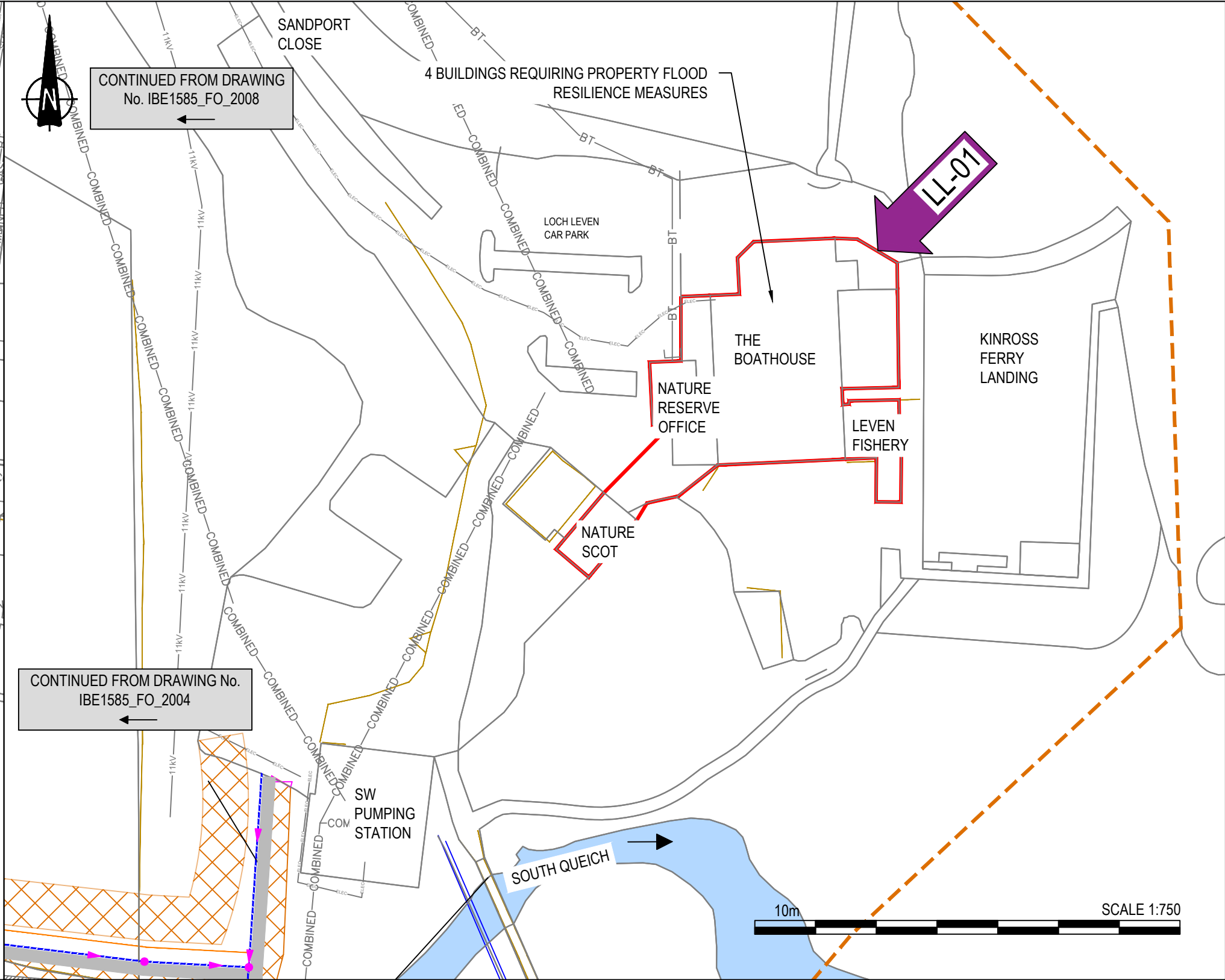

PROPERTY FLOOD
RESILIENCE LOCATION

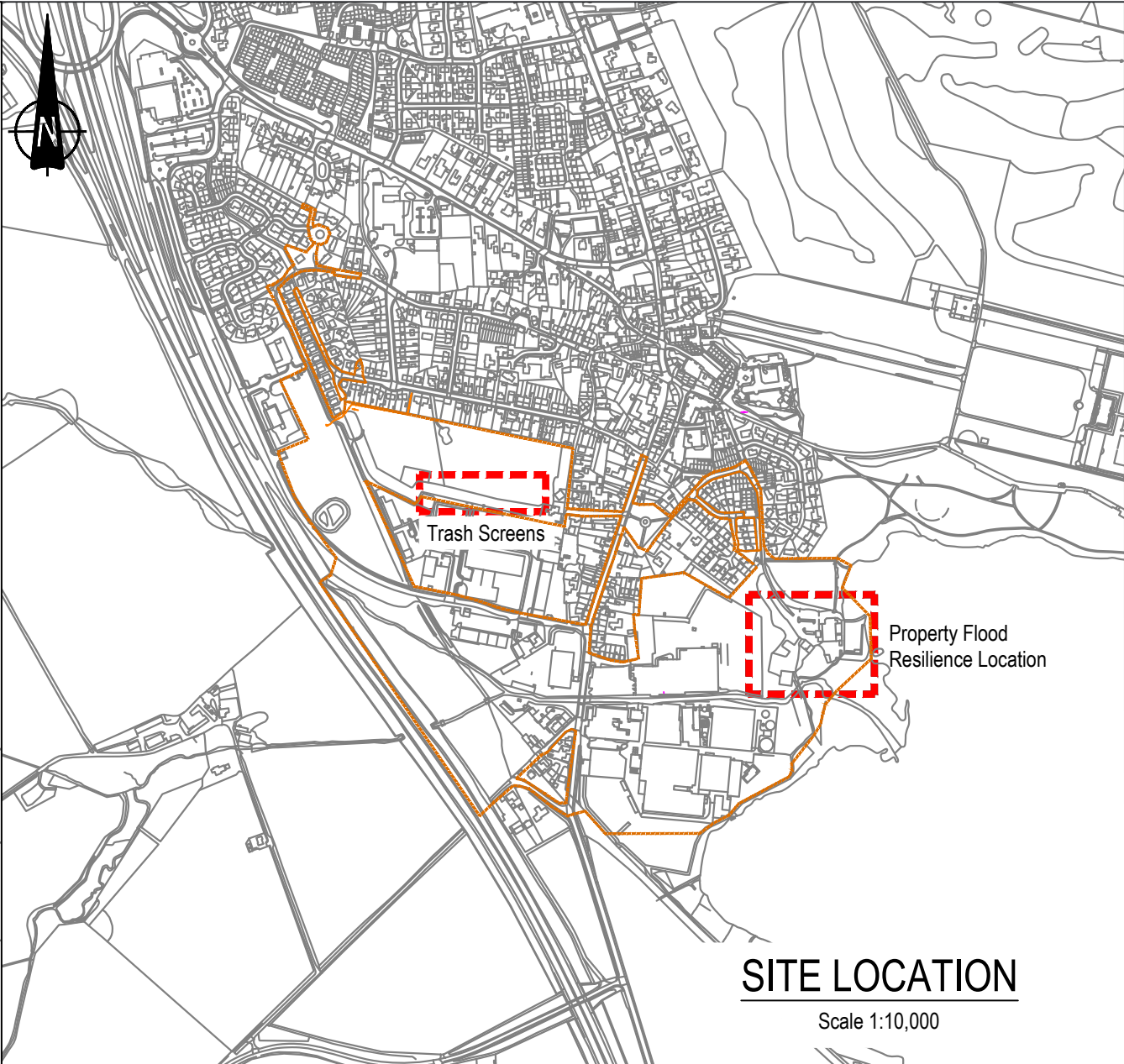

SITE LOCATION
Scale 1:10,000

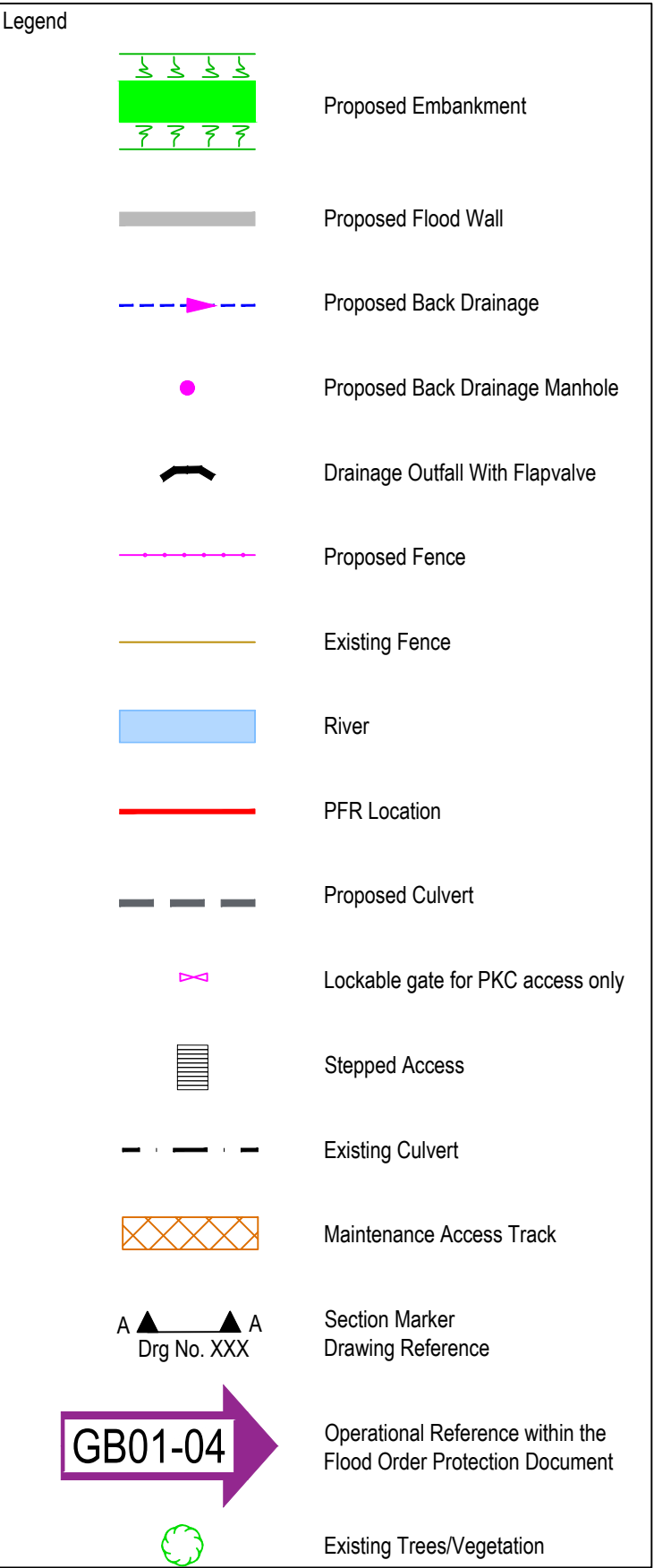

Refer to Drg. No. IBE1585_FO_2001 for Embankment Plan View

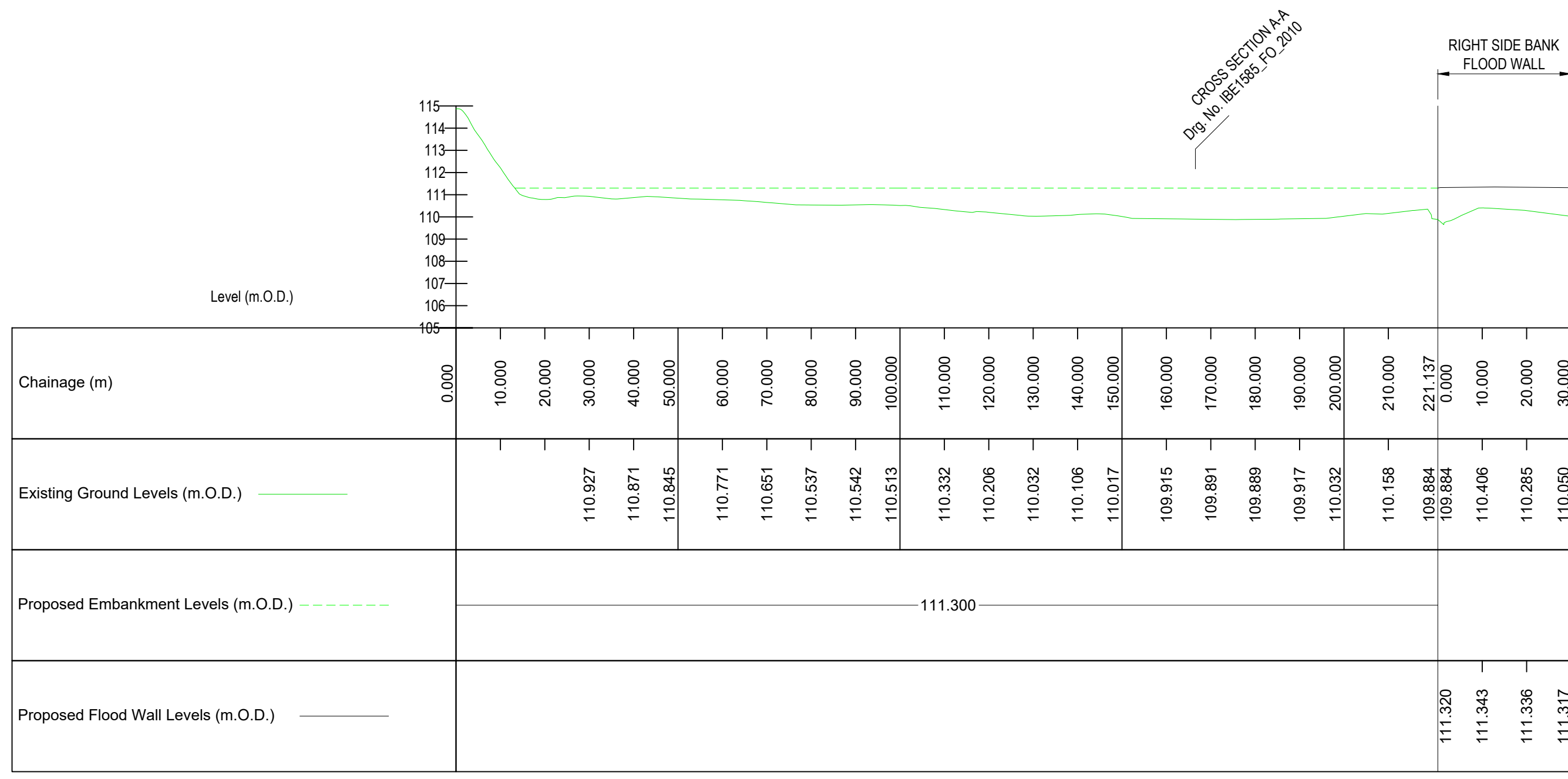

QUEICH PLACE EMBANKMENT - LONGSECTION
SCALE: H 1:1000,V 1:200. DATUM: 100.000

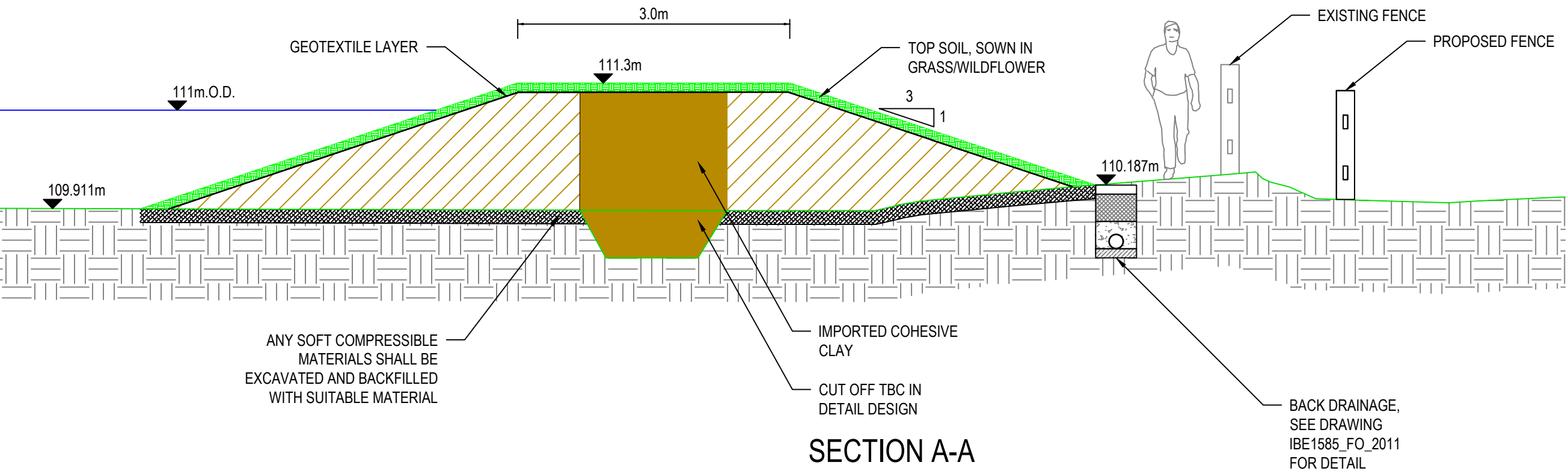

SECTION A-A
SCALE 1:50

Refer to Drg. No. IBE1585_FO_2001 for Embankment Plan View

- NOTES
- Flood Risk Management (Scotland) Act 2009. This plan is in accordance with the requirements of section 60 and schedule 2 of the flood risk management (Scotland) act 2009.
 - This drawing is to be read in conjunction with the South Kinross Flood Protection Scheme Description 2024
 - Existing Services. Information received from statutory undertakers has been used to identify locations of services. Exact locations of these services will be determined during detailed design. Service diversions are required to enable to construction of the scheme. Diversion of Services will be carried out by or on behalf of the statutory undertaker under its own statutory powers, not the local authority under the act. All service locations have been identified and will be protected or diverted as appropriate; specifications and working methods will be agreed with the relevant undertakers prior to construction.
 - Issue of Drawings. Hard copies, dwf and pdf will form a controlled issue of the drawing. All other formats (dwg, dxf etc.) are deemed to be an uncontrolled issue and any work carried out based on these files is at the recipient's own risk. RPS will not accept any responsibility for any errors arising from the use of these files, either by human error by the recipient, listing of un-dimensioned measurements, compatibility issues with the recipient's software, and any errors arising when these files are used to aid the recipients drawing production, or setting out on site.
 - Flood levels shown relate to the 0.5% AEP storm with 0.3m Freeboard
 - All outfalls discharging to the South Queich and Gelly Burn, identified within the operations will incorporate appropriate back flow prevention measures
 - Due to the uncertain nature of tree root zones, the status of existing trees as indicated on this plan may be altered during the development of the design and method to construct operations. Trees within the footprint of works will require removal to facilitate the operations. This will be mitigated through recommendations in the Environmental Impact Assessment which includes compensatory planting.

THIS IS THE PLAN MARKED IBE1585_FO_2010 REFERRED TO IN THE FLOOD PROTECTION SCHEME FOR SOUTH KINROSS FLOOD PROTECTION SCHEME 2024

PROPER OFFICER

(Signature)

FOR PERTH AND KINROSS COUNCIL

(date)

C	Final FRM Act Notification	NM	12/03/2024
B	FRM Notification Client Comments	NM	01/02/2024
A	Draft FRM Act Notification	NM	30/11/2023
rev	amendments	check	date

rps Elmwood House
74 Boucher Road
Belfast
BT12 6RZ

T +44 (0) 28 90 667914
F +44 (0) 28 90 668286
W www.rpsgroup.com/ireland
E ireland@rpsgroup.com



Client

South Kinross Flood Protection Scheme

Title

Flood Protection Operations The Myre (CB02), Loch Leven (LL01) Plans and Gelly Burn Embankment Sections (GB01)

Project Number	Sheet Size	Drawing Scale
IBE1585	A1	As Shown

Drawing Number

IBE1585_FO_2010

Drawn By	Status	Revision
NM	F01	C

Checked By	Approved By	Date
AMcG	SP	12/03/2024